



Due to its narrow and innovative construction, high level of user friendliness and long service life, the SH 4 sets new standards for quality and cost effectiveness. Its very compact design despite a high pressing force and a weight of only 110 kg allows ergonomic operation even on mobile jobs. The long base jaws enable pressing up to 1½" 4 SP, the proven greaseless slide bearing technology reduces maintenance costs and increases production quality.



SH 4 Ecoline



SH 4 Mobileline

SH 4 C.2



SH 4 Ecoline

SH 4 Mobileline

Technical Data	SH 4 Ecoline	SH 4 Mobileline
Crimp force (kN/Ton)	1,800/180	1,800/180
No grease: 20% less friction	✓	✓
Control	Control A	Control A
4-spiral + 1-pc fittings*	2"	2"
4-spiral + 2-pc fittings*	2"	2"
4/6-spiral + 2-pc fittings*	1½" (6-sp 1¼")	1½" (6-sp 1¼")
Industry hose	2"	2"
90° Elbows	1¼"	1¼"
Max. Crimp range (mm/inch)	70 / 2.76	70 / 2.76
Opening (mm/inch)	+27 / +1.06	+27 / +1.06
Opening without dies (mm/inch)	97 / 3.82	97 / 3.82
Master dies length (mm/inch)	110 / 4.33	110 / 4.33
Type of dies	239-xx-Ø	239-xx-Ø
Press path (mm)	12	12
Speed (mm/sec)		
Close	2.0	3
Crimp	2.0	1
Open	7.6	10
Noise level	69 dBA	69 dBA
Drive	3 kW 3~VAC	1,8 kW 1~VAC (new with double pump)
Oil	35 l	4 l
L x W x H (mm)	600 x 550 x 630	430 x 370 x 440
Weight (kg)	150	110 (without power unit)
<b>Options</b>		
12 VDC/24 VDC	–	✓
1~VAC	✓	✓
Control C.2/IPC	✓	–
PB 239-MD-Ø 70 (Closing pin for master dies SH 4)	✓	✓

\* According to the fitting. \*\* Not suitable for GDC 239.5. Packages page 28 / Accessories and options page 50

## Type of dies



Ø mm	mm
6.8	65
9	65
10	65
12	65
14	65
16	65
17	65
19	65
20	65
22	65
24	65
26	65
28	80
30	80
31	80
32	80
34	80
36	80
38	80
39	80
40	80
44	80
47	100
50	100
54	100
57**	100
62**	100

## Description



The 12 VDC/24 VDC units offer space- and weight-saving application options, e.g. for fitting service trucks.  
L x W x H (mm):  
441 x 291 x 296; 21 kg



PB 239-MD-Ø 70  
Closing Pin for Master dies  
SH 4.  
(Ø 70 mm)



For mobile applications the SH 4 Mobileline is also ideally suitable.

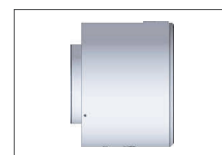

SH = Hollow piston press tool